



# Ferndale

Safety

Toll-Free: 855-326-1243  
<https://www.ferndalesafety.com>

## MODEL TF LATHE CHUCK SAFETY SHIELD INSTALLATION GUIDE

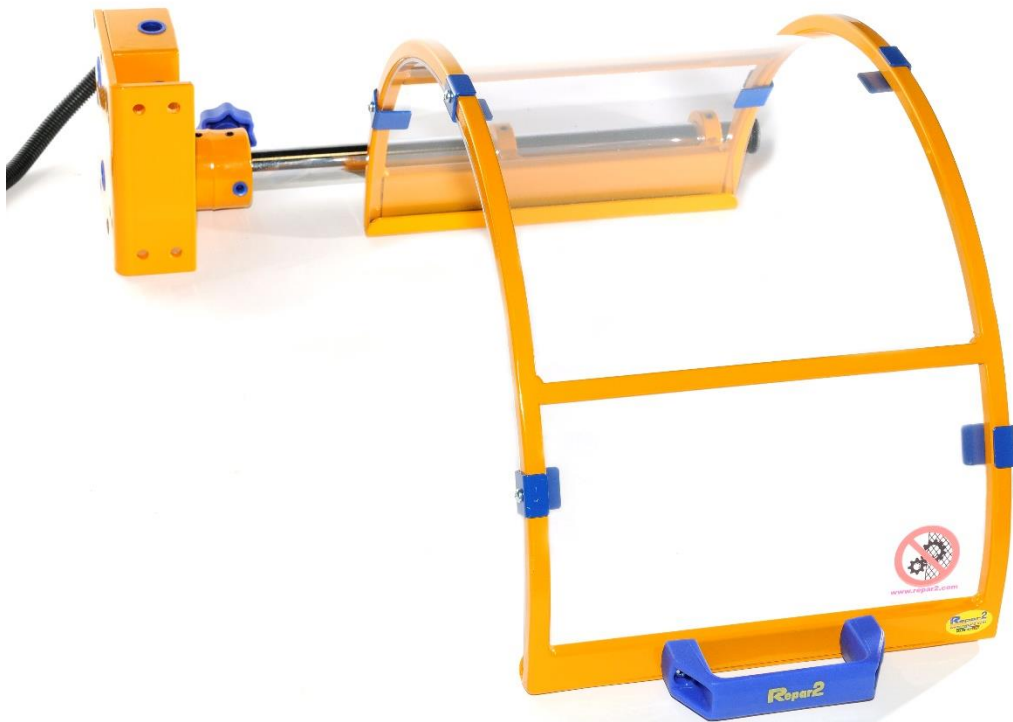

Thank you for the purchase of our lathe chuck guard. We have made this installation guide to help you set up and use this product. This guide assumes that you are familiar with drilling, tapping, and fabricating simple brackets. If you need any extra help, please call us at 855-326-1243.

## **IDENTIFICATION OF COMPONENTS**

Before installation, please make sure you have all components.

You should have:

- One (1) shield assembly
- One (1) mounting posts with wiring

The shield assembly gets installed onto the mounting post.

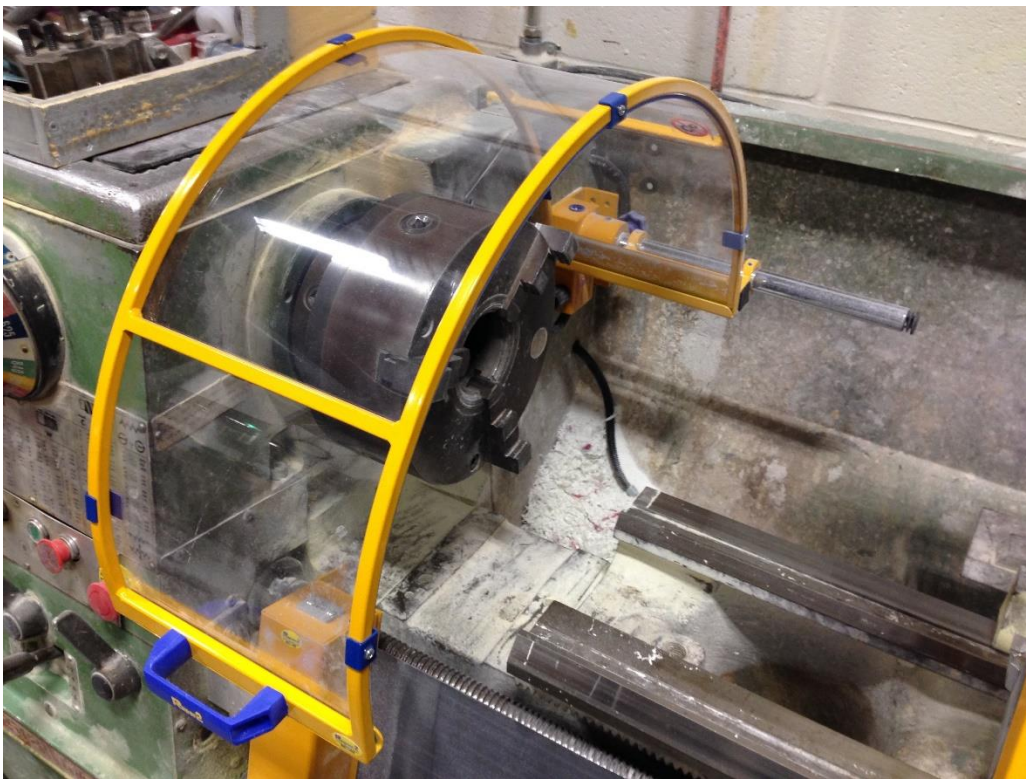
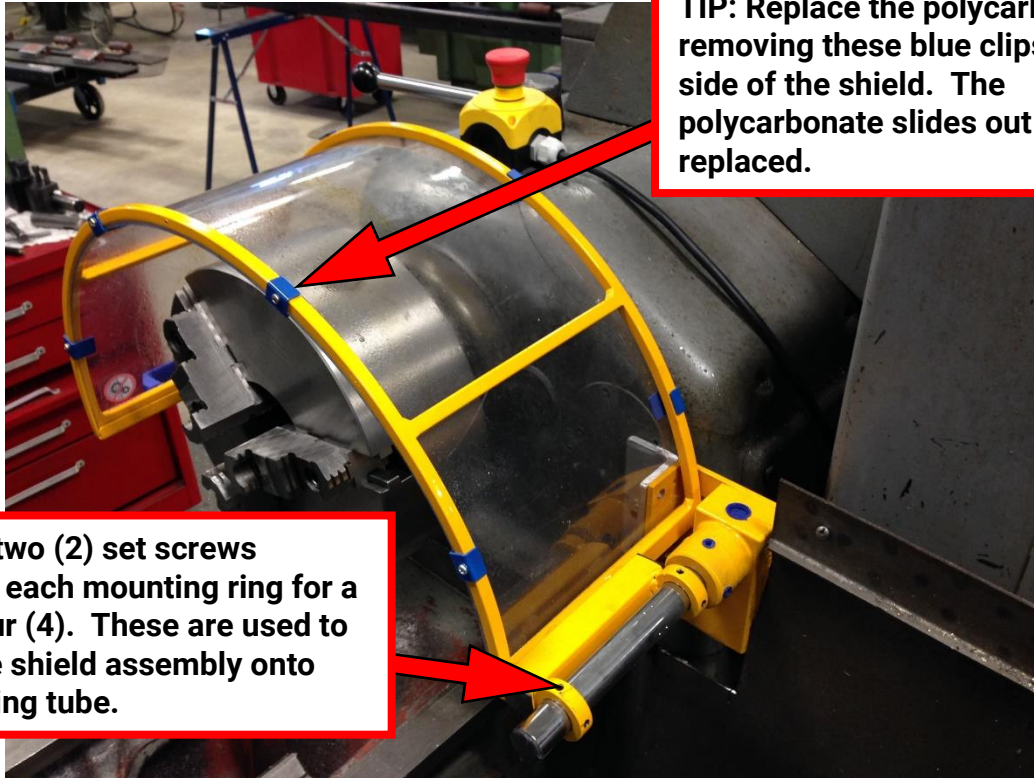

*Figure 2: TF chuck guard installed on a typical lathe*

## **INSTALLATION**

1. Slide the screen onto the mounting bracket. Insert the tube on the mounting bracket into the two welded rings on the shield. Make sure that the set screws on the shield's rings are all out so that they do not interfere with this step.

Once the shield is on the tube, do not tighten the set screws yet. Hold the whole guard above to lathe chuck to verify the positioning and fit. Make sure it is centered on the chuck and pay special attention to the location of the mounting bracket. Take note if you need to fabricate additional brackets for proper mounting of the guard.



**TIP: Replace the polycarbonate by removing these blue clips off one side of the shield. The polycarbonate slides out and can be replaced.**

**There are two (2) set screws located on each mounting ring for a total of four (4). These are used to tighten the shield assembly onto the mounting tube.**

*Figure 3: Note that an extra angle bracket was needed to mount this guard in the proper position.*

2. Remove the shield from the mounting bracket. There is a total of eight mounting holes on the bracket. You need to use only two. Drill and tap  $\frac{1}{4}$ "-20 mounting holes into the headstock.
3. Once you have solidly mounted the bracket to the headstock in the right position, twist the tube in a counterclockwise direction until it stops.
4. Slide the shield back onto the mounting tube and tighten all four set screws.

## **ADJUSTMENT**

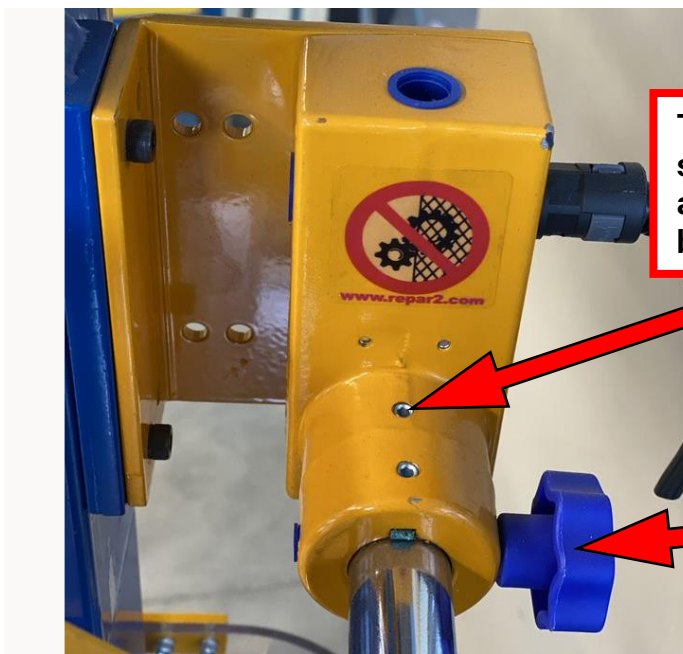

**Tighten or loosen these two set screws to adjust the screen tension, and prevent the screen from falling by itself.**

**Do not adjust this knob – It is used for the rotational stop.**

## ELECTRICAL CONNECTION

Contact Rating: 3A @ 240VAC, 0.1A @ 240VDC

Wire Color Codes and Sample Wiring Diagram:

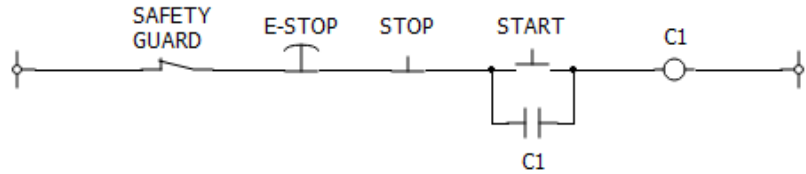
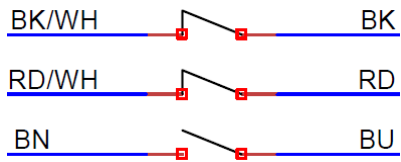

**IMPORTANT:** Do not connect the switch directly to the motor. The switch was not designed to handle motor loads. Wire the switch inside the control circuit only. If you require any help with this, please call us at 855-326-1243.

## SPARE PARTS

For spare parts and accessories, contact us here: <https://www.ferndalesafety.com/contact-us/>